



FREEZERS

display freezer range





explore the world of refrigeration equipment

TABLE OF CONTENT

4	PLUG & PLAY REFRIGERATION EQUIPMENT
8	GREEN WAVE R290 PRODUCT LINE
12	HYDROLOOP SYSTEM
18	FREEZER RANGE
20	ERIDA ERIDA ERIDA SLIM
28	DELTA
34	HELLA
40	LEDA LEDA LEDA COMPACT
48	SERVE-OVER FREEZERS VEGA SPACE QB FREEZER VEGA QB FREEZER
58	ACCESSORIES
60	OPTIONS
60	ICON LEGEND
62	CONTACTS

PLUG & PLAY REFRIGERATION EQUIPMENT

simple and easy refrigeration for your store

Plug-in refrigeration equipment is designed so that every unit has its own refrigeration cycle. All components, including compressor, condenser, thermoregulation valve and evaporator are fitted inside the cabinet thus creating lots of advantages. The heat of condensation can be released into the surrounding environment or can be carried outside by a Hydroloop system (see p. 12).





PLUG & PLAY REFRIGERATION EQUIPMENT

THE LINE HAS THE FOLLOWING CHARACTERISTICS:

| Energy efficiency

Plug & Play equipment is fitted with effective hermetic compressors excellently operating in various temperatures.

| Environmental friendliness

Up to 80% less refrigerant compared to remote systems is required and its leakage percent is minimum (0–4%), thus making the system 'green' and also maintenance cost-effective.

| Cost-effectiveness

The need for special refrigeration room and long copper pipelines is eliminated, guaranteeing up to 70% cheaper system installation and ensuring easy care.

| Flexibility

Equipment can be easily relocated, new equipment can be added at any time without closing the store.

| Maximum food safety

Every refrigerator operates as a separate unit, therefore failure in one piece of equipment does not affect the others, and potential loss of products is minimised.

| Quicker and cheaper installation

All refrigeration components are factory integrated, no need for welding on site.

| Convenient repairs and component replacement

Easy access to all the components of the refrigeration equipment.



GREEN WAVE R290 PRODUCT LINE

future-proof refrigeration solution

We have developed a range of stand-alone products, based on natural refrigerant propane R290. Each display case runs off its own propane system. R290 is the future-proof refrigerant - both green and featuring excellent thermodynamic properties. This technology enables stores to reduce energy consumption and limit their environmental impact.





GREEN WAVE R290 - PLUG-IN RANGE

Green Wave R290 – is the line of advanced plug-in products using environmentally-friendly propane gas R290 as the refrigerant.

BENEFITS:

- | **Environmentally-friendly**
Natural refrigerant with the global warming potential (GWP) = 3.
- | **Lower investment costs**
No need for special room for a compressor unit, thus saving the shop area.
- | **Lower electricity consumption costs**
This type of equipment operates under low pressure and is up to 30% more energy efficient than HFC operated.
- | **Lower installation costs**
Everything is mounted in the factory, thus eliminating the need for specialists.
- | **Simpler and cheaper technical maintenance and service.**

R290 CHARACTERISTICS:

- | Naturally occurring hydrocarbon.
- | GWP = 3, ODP = 0.
- | Readily available and affordable.
- | EPA-approved in commercial refrigeration applications.
- | High-efficiency, high performance, reliable.
- | Safe to use when proper protocols are followed.



HYDROLOOP SYSTEM

economical option for refrigeration at your store

Hydroloop is fully integrated refrigeration technology which eliminates the need for complicated refrigeration systems and extremely simplifies system mounting works.

Hydroloop system connects the plug-in refrigeration equipment to a closed cycle water-cooled loop, in which excess condensation heat is removed through simple piping to the exterior of a building.

Environmentally-friendly propylene glycol solution is used for heat removal. Water pump ensures glycol circulation and outdoor dry cooler is used to carry out the residual heat.

This innovative system guarantees high efficiency, faster shop installation, saves space, gives freedom of equipment relocation, uses small quantities of refrigerant and is simple to look after.



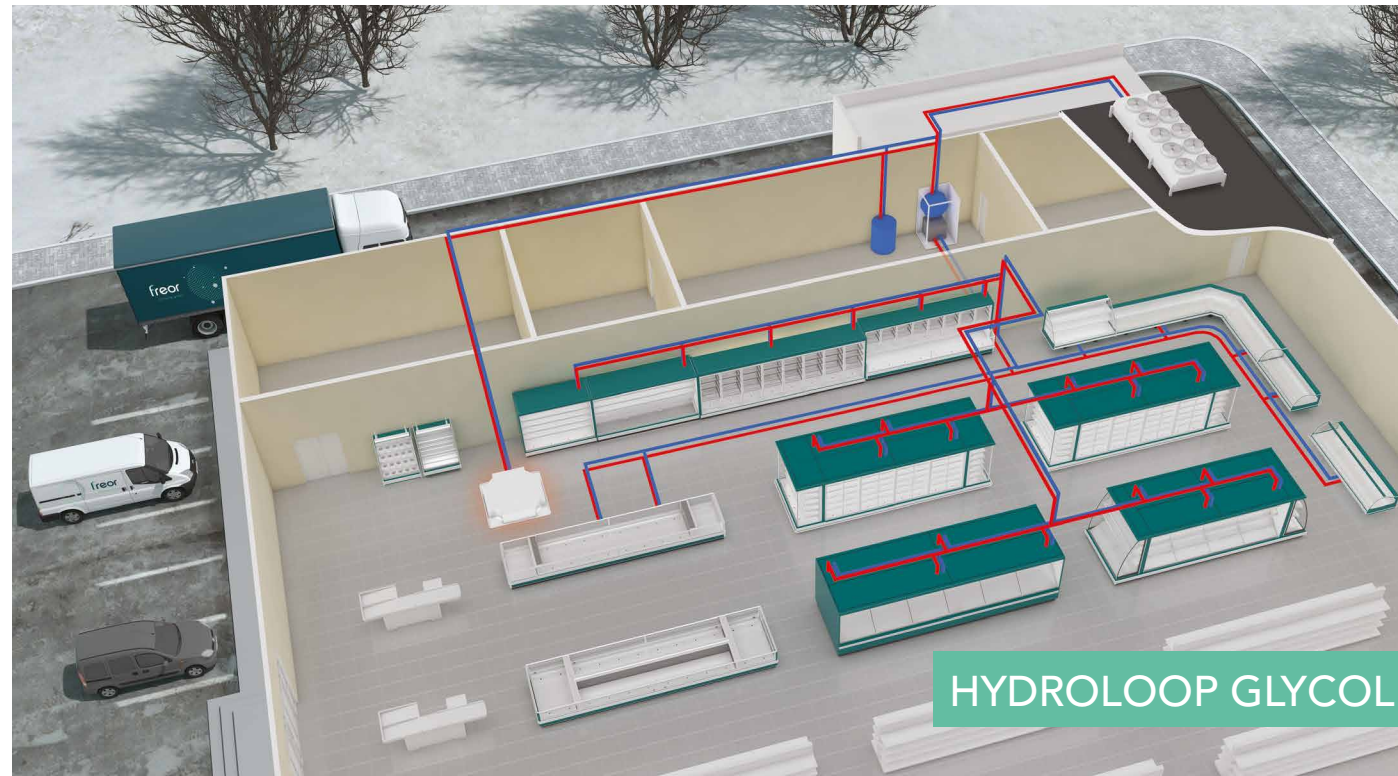

HYDROLOOP HYBRID SYSTEM

This solution allows combining two different heat removal systems with the possibility to switch over the regimes, which guarantees easy use of excess heat for shop needs. Heat is either emitted directly into the shop via air condenser mounted in the equipment (in winter) or removed from the shop via glycol line to the outside (in summer). It allows heating of the shop when needed.

BENEFITS:

- | Direct warm air supply to the shop in winter
- | Easy to install
- | Easy to integrate with various heating systems
- | Hydroloop system can be connected after installation of the refrigerators
- | Reliable operation – in case of fault in water circulation, heat is removed via air condenser on the top of the equipment



HYDROLOOP GLYCOL SYSTEM

This environmentally-sustainable solution allows removal of heat from the shop through environmentally-friendly glycol line in summer and additional use of the heat for warming up the shop and water in winter. Decentralised operation of refrigeration equipment allows avoiding losses which could be caused by interruption in central refrigeration system. Your chosen heating system can be additionally installed according to your needs.

BENEFITS:

- | No heat discharge into the shop
- | Very small quantity of refrigerant
- | Easy installation – saving costs
- | No additional room height is needed to secure air flow
- | Emitted heat can be used for shop heating
- | Easy to integrate with various heating systems

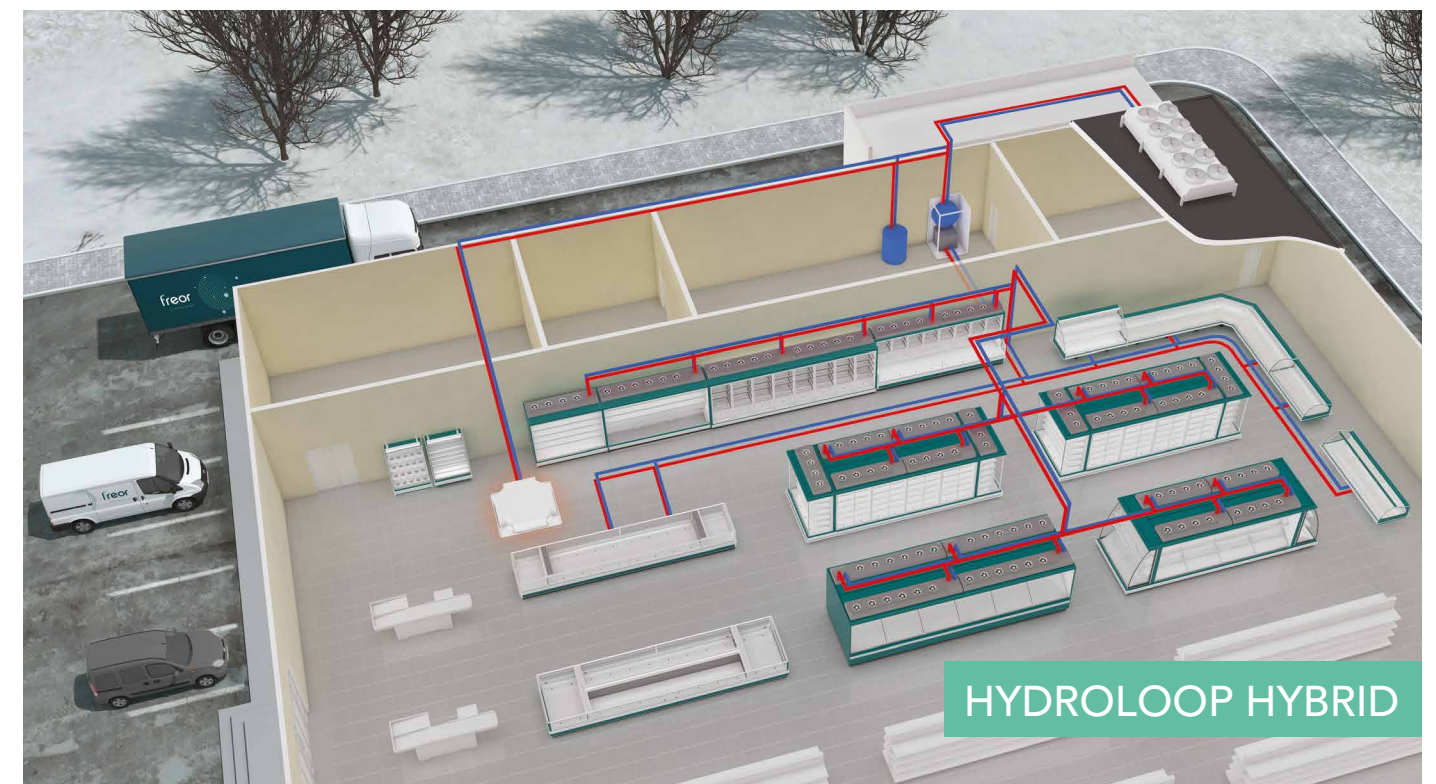



HYDROLOOP WPI SYSTEM

Hydroloop WPI (Water Pump Integrated) System is the waterloop technology in which each of the refrigeration appliances contains an integrated small-sized circulatory water pump, eliminating the need for the main pump station in the waterloop system. The individual high-efficiency integrated water pumps run in sync with the operation of compressors, maximum 16 h per day (24 h), compared to the main pump station running 24/7 in traditional Hydroloop System, resulting in approximately 30 % energy saving on glycol circulation operation.

Hydroloop WPI System is a perfect solution for stores of smaller sales area size, such as petrol stations and convenience stores.

BENEFITS:

- | Even more space-saving
- | Increased energy-efficiency
- | Simplicity & flexibility
- | Environmental sustainability
- | Reliability



1. Circulatory water pump



ADVANTAGES OF THE HYDROLOOP SYSTEM

ENERGY EFFICIENCY

- | Energy-efficient compressors (up to 25% energy saving)
- | Discharged condensation heat can be used to warm up the shop

ENVIRONMENTAL FRIENDLINESS

- | Up to 80% smaller quantity of refrigerant
- | Refrigerant leakage only 0–5% (for remote – 10-15%)
- | Environmentally-friendly glycol solution is used
- | Natural refrigerant propane R290 available

BETTER FLEXIBILITY

- | Location of the equipment can be easily changed in the shop

LOWER INVESTMENTS INTO SHOP INSTALLATION

- | No need for complex and costly central refrigeration system
- | Equipment is factory fitted with all necessary refrigeration components and pipes for easy system connection
- | Cheaper installation (no need for copper pipelines and specialised experts)
- | Saving shop area

COST-EFFECTIVE MAINTENANCE

- | Easy replacement of components or unit of equipment without stopping the whole system
- | Lower need for maintenance
- | Every refrigerator operates as a separate unit, potential loss of products in case of a unit failure is minimised

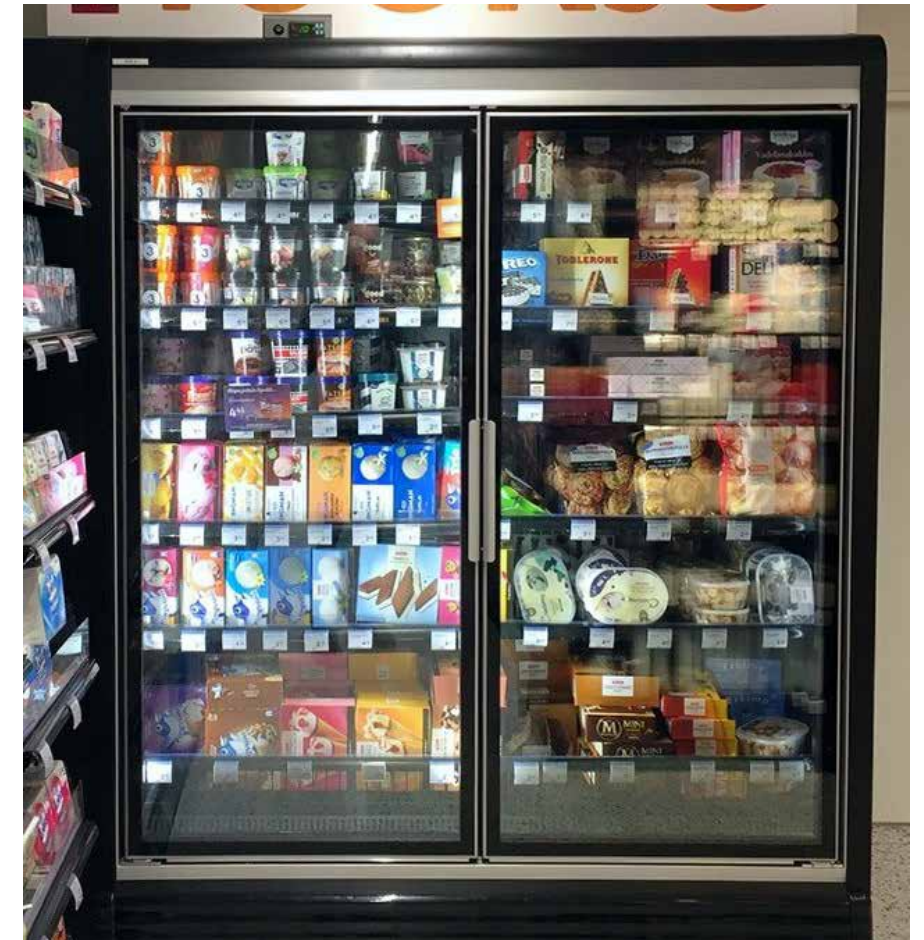

FREEZER RANGE

to increase the sales of products

FREOR offers various commercial freezer models for frozen products self-service which allows retailers to choose the display options most suited to their requirements. Our freezer range features upright glass door freezers, freezer islands, and negative temperature serve-overs. Most models are available with R290 propane as a natural refrigerant.





ERIDA
to maximize the sales of displayed frozen goods



ERIDA

This low temperature multideck freezer cabinet ensures the preservation of frozen foods at temperatures of -18 to -21 °C, and -22 to -24 °C. The temperature is evenly distributed throughout all the inner spaces between the shelves. Large-sized glass panels provide an outstandingly clear view of the products even from a distance. Anti-condensation foil on the internal pane reliably prevents any fogging after opening. It is a convenient and cost-effective solution for any type of store. Multiplexible with other cabinets.

OPTIONS:

- | Doors LED lighting
- | Stainless steel bumper / protection rails
- | Endwall alternatives (panoramic; solid)
- | Hot gas defrost (in use with R290)

KEY BENEFITS:

- | Alternative depths and heights
- | Front bumper
- | Multiplexible device
- | Glass doors
- | Wide choice of colors for the exterior and interior (RAL pallet)
- | Bimetallic thermometer with holder
- | Defrost heater
- | Polyurethane thermal insulation CFC free

MM	1560	2340	3120	3900
°C	N/A			



	HFC / HFO	CO ₂	R290
PLUG-IN	✓		✓
REMOTE	✓	✓	
HYDROLOOP	✓		✓



ERIDA SLIM

With its small footprint, vertical freezer Erida Slim was designed to meet the needs for narrow exposition depth in small stores, mini markets and convenience stores. It fits into any store architecture and is a perfect solution for the sales of various frozen foods. Product features reduced energy consumption and elegant design which enhances the displayed products. Erida Slim can be multiplexed to obtain lines of various lengths.

OPTIONS:

- | Doors LED lighting
- | Stainless steel bumper / protection rails
- | Endwall alternatives (panoramic; solid)
- | Hot gas defrost (in use with R290)

KEY BENEFITS:

- | Optimized dimentions to fit in any store layout
- | Alternative depths and heights
- | Front bumper
- | Multiplexible device
- | Glass doors
- | Wide choice of colors for the exterior and interior (RAL pallet)
- | Bimetallic thermometer with holder
- | Defrost heater
- | Polyurethane thermal insulation CFC free

mm	1560	2340	3120	3900
°C	N/A			



	HFC / HFO	CO ₂	R290
PLUG-IN	✓		✓
REMOTE	✓	✓	
HYDROLOOP	✓		✓

Model	Lenght without endwalls (mm)	Operating temperature °C (+25 °C, 60% RH)	Exposition space (m²)	Volume (m³)	Rated voltage (V)
Erida L / Erida L plug-in	1560	-18....-21 / -22....-24 °C	4.68	1.59	400
	2340		7.02	2.39	
	3120		9.36	3.18	
	3900		11.70	3.98	
Erida H / Erida H plug-in	1560	-18....-21 / -22....-24 °C	5.60	1.79	400
	2340		8.40	2.69	
	3120		11.20	3.59	
	3900		14.00	4.49	
Erida Slim L plug-in	1560	-18....-21 / -22....-24 °C	3.37	1.18	400
	2340		5.05	1.76	
	3120		6.74	2.35	
	3900		8.42	2.94	
Erida Slim H plug-in	1560	-18....-21 / -22....-24 °C	4.02	1.33	400
	2340		6.04	1.99	
	3120		8.05	2.65	
	3900		10.06	3.31	

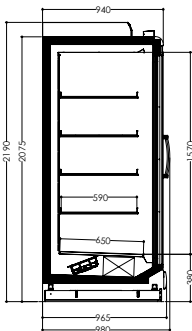

Erida L

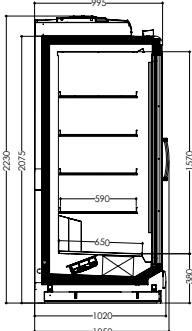

Erida L plug-in

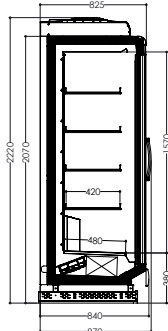

Erida Slim L plug-in

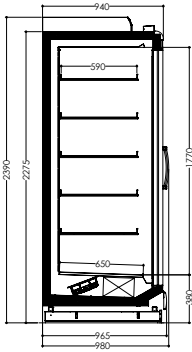

Erida H

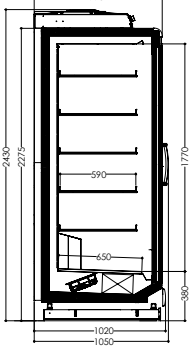

Erida H plug-in

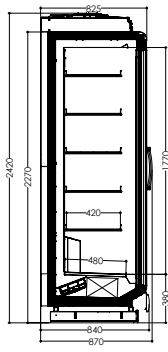

Erida Slim H plug-in



DELTA
convenient product display at two levels



DELTA

This combi vertical freezer combines the advantages of both, a chest freezer and a freezer cabinet. Delta is designed for the display of ice-creams and frozen produce. It has a large loading capacity, wide display, non heated triple-glazed doors with ergonomic handles, which feature high thermal insulation and is an energy efficient solution. Glass lids on the chest results in an extra energy saving. Delta is a powerful sales tool for any layout supermarket. Multiplexible with other cabinets.

OPTIONS:

- | LED lighting for chest freezer part
- | Stainless steel bumper / protection rails
- | Push or slide glass lids

KEY BENEFITS:

- | Alternative depths and heights
- | Front bumper
- | Multiplexable device
- | LED lighting for freezer cabinet
- | Wide choice of colors for the exterior and interior (RAL pallet)
- | Bimetallic thermometer with holder
- | Energy-saving electronically commutated fans
- | Defrost heater
- | Polyurethane thermal insulation CFC free

mm	1880	2500	3750		
°C	N/A				

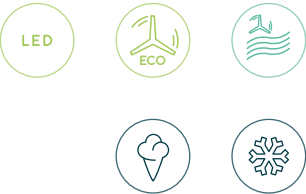

	HFC / HFO	CO ₂	R290
PLUG-IN	✓		✓
REMOTE	✓	✓	
HYDROLOOP	✓		✓

Model	Lenght without endwalls (mm)	Operating temperature °C (+25 °C, 60% RH)	Exposition space (m²)	Volume (m³)	Rated voltage (V)
Delta L / Delta L plug-in	1880 2500 3750	-18...-22 °C	3.92 5.00 7.49	1.47 1.94 2.91	400
Delta H / Delta H plug-in	1880 2500 3750	-18...-22 °C	4.66 6.49 9.32	1.59 2.12 3.19	400

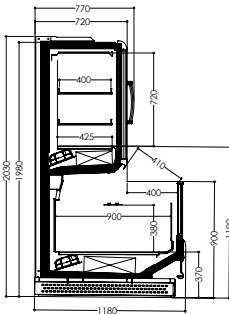

Delta L

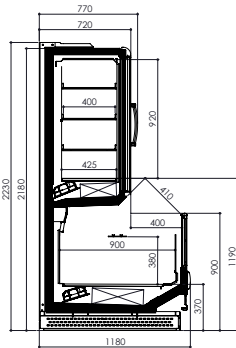

Delta H

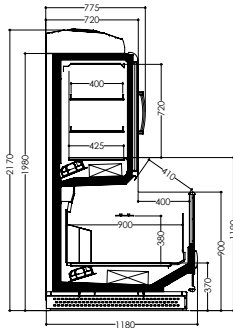

Delta L plug-in

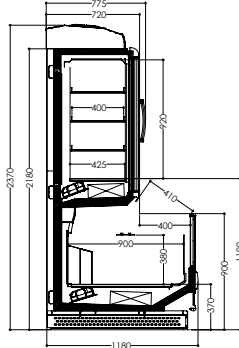

Delta H plug-in



HELLA
maximum product volume with minimum footprint



HELLA

This wide dual-compartment freezer island is ideal for displaying pre-packed frozen foods and ice creams. Stylish design with high panoramic glass provides maximum visibility of the merchandise. Available with push or sliding glass lids for reduced energy consumption. Cases can be multiplexed to obtain islands of various lengths. A combination with end units draws the customer's eye along the whole display. Superstructures with one or two rows of shelves with integrated lighting are available – the perfect solution for optimizing the sales area.

OPTIONS:

- | Interior LED lighting
- | Stainless steel bumper / protection rails
- | Curved or plane glass lids
- | Push or slide glass lids
- | The superstructure of 1 or 2 shelves and lighting

KEY BENEFITS:

- | Sturdy construction suitable for huge loads
- | Front bumper
- | Multiplexible device
- | Protection against glass fogging
- | Wide choice of colors for the exterior and interior (RAL pallet)
- | Bimetallic thermometer with holder
- | Energy-saving electronically commutated fans
- | Defrost heater
- | Polyurethane thermal insulation CFC free

MM	1880	2500	3750		
°C	N/A				



	HFC / HFO	CO ₂	R290
PLUG-IN			
REMOTE	✓	✓	
HYDROLOOP			✓

Model	Lenght without endwalls (mm)	Operating temperature °C (+25 °C, 60% RH)	Exposition space (m²)	Volume (m³)	Rated voltage (V)
Hella	1880	-18....-21 / -22....-24 °C	3.00	1.20	400
	2500		3.99	1.60	
	3750		5.99	2.40	
Hella R290	2500	-18....-21 / -22....-24 °C	3.99	1.60	400
	3750		5.99	2.40	

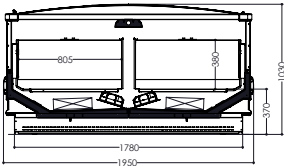

Hella

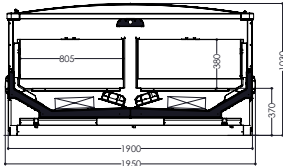

Hella R290





LEDA
ideal fit for smaller store layout



LEDA

Refrigerated island for the preservation and display of packed ice-creams and frozen products. Perfect for furnishing small and medium-size sales areas. Leda has the flexibility to be used as a single unit or to be grouped together to form lines. Endcases can be used to display special promotions to help enhance merchandising. Available with a push or sliding glass lids for reduced energy consumption. Possibility to install superstructures with one or two rows of shelves – it provides an excellent view over merchandise and optimizes sales area at the same time.

OPTIONS:

- | Interior LED lighting
- | Stainless steel bumper / protection rails
- | Curved or plane glass lids
- | Push or slide glass lids
- | The superstructure of 1 or 2 shelves and lighting

KEY BENEFITS:

- | Sturdy construction suitable for huge loads
- | Front bumper
- | Multiplexible device
- | Protection against glass fogging
- | Wide choice of colors for the exterior and interior (RAL pallet)
- | Bimetallic thermometer with holder
- | Energy-saving electronically commutated fans
- | Defrost heater
- | Polyurethane thermal insulation CFC free

	1880	2500	3750		
	N/A				



	HFC / HFO	CO ₂	R290
PLUG-IN			✓
REMOTE	✓	✓	
HYDROLOOP			✓

LEDA R290

Leda plug-in R290 features a modular design, which allows combining individual units into the lines of various lengths. Product display area is surrounded by glass walls providing maximum product visibility. Leda plugin R290 has a built-in compressor, which allows individual refrigeration process with a very small amount of refrigerant required. The freezer can be connected to Hydroloop system to remove the excess heat via glycol line, ensuring perfect refrigeration performance with minimum energy consumption.



MM	2500	3750			
°C	N/A				

	R290
PLUG-IN	✓
REMOTE	
HYDROLOOP	✓

LEDA COMPACT R290

Leda Compact R290 is a reduced size yet spacious freezer island, specially designed for smaller shopping spaces. Optimized dimensions Leda Compact R290 operates with natural refrigerant propane in a semi plug-in mode, connected to a glycol-cooled system Hydroloop, and is an excellent green choice for stores with limited trade area. Thanks to panoramic glass walls of this freezer island, the frozen merchandise can be seen at a glance. With push glass lids for reduced energy consumption.

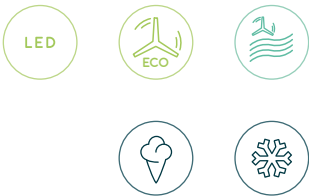

MM	2500	3750			
°C	N/A				

	HFC / HFO	CO ₂	R290
PLUG-IN			
REMOTE	✓	✓	
HYDROLOOP			✓

Model	Lenght without endwalls (mm)	Operating temperature °C (+25 °C, 60% RH)	Exposition space (m²)	Volume (m³)	Rated voltage (V)
Leda	1880 2500 3750	-18....-21 / -22....-24 °C	1.95 2.59 3.88	0.74 0.98 1.47	400
Leda R290	2500 3750	-18....-21 / -22....-24 °C	2.59 3.88	0.98 1.47	400
Leda RV R290	2500 3750	-18....-21 / -22....-24 °C	2.90 4.35	0.93 1.39	400
Leda Compact R290	2500 3750	-18....-21 / -22....-24 °C	1.84 2.76	0.70 1.05	400

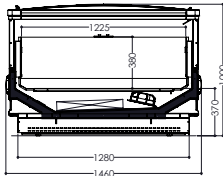

Leda

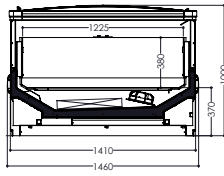

Leda R290

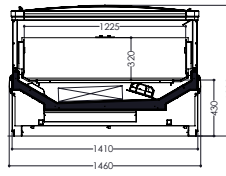

Leda RV R290

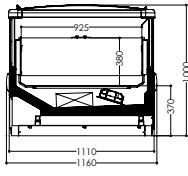

Leda Compact R290



SERVE-OVER FREEZERS

frozen merchandise is shown at its very best



VEGA SPACE QB FREEZER

A cubic design commercial display freezer counter with sliding back doors and additional glass pack, designed to store and sell frozen products. Classic, simple lines and wide display surface make it an ideal choice for any store format. Multiplexible device looks unanimously when used with other Vega Space QB range counters. Stable and reliable performance guarantees the perfect preservation of your merchandise.

OPTIONS:

- | The LED lighting in high glass design
- | Galvanized steel or stainless-steel display surface
- | Stainless steel bumper
- | The LED counter base lighting (floor illumination)
- | Defrost heater

KEY BENEFITS:

- | Sturdy stainless steel display surfaces
- | Strong tempered glass
- | Lifiable front glass
- | Protection against glass fogging
- | Multiplexible device
- | Possibility to lift the bottom of the counter to clean and tidy it
- | Wide choice of colors for the exterior and interior (RAL pallet)
- | Even allocation of cool air throughout the whole area
- | Energy-saving electronically commutated fans
- | Electronic control panel
- | Polyurethane thermal insulation CFC free
- | Sliding back doors

MM	2500				
°	N/A				

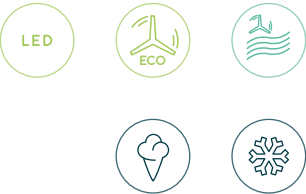

	HFC / HFO	CO ₂	R290
PLUG-IN	✓		✓
REMOTE	✓	✓	
HYDROLOOP	✓		✓

Model	Lenght without endwalls (mm)	Operating temperature °C (+25 °C, 60% RH)	Exposition space (m²)	Volume (m³)	Rated voltage (V)
Vega Space QB Freezer	2500	-12...-15 °C	2.02	0.54	400

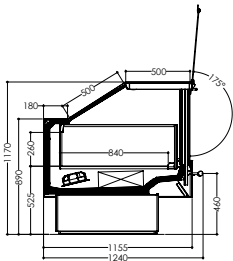

Vega Space QB Freezer





VEGA QB FREEZER

A cubic design serve-over counter for frozen meat, fish and packed products. Classic, simple lines and wide display surface makes it a great choice for any store format, be it a food market or supermarket. A multiplexible device looks unanimously when used with other Vega QB range counters. Stable and reliable performance guarantee the perfect preservation of frozen food products.

OPTIONS:

- | The LED lighting in high glass design
- | Low glass design for self-service
- | Sliding doors
- | Galvanized steel display surfaces (any color of RAL pallet)
- | Lift-up glass with gas springs
- | Tilt down glass

KEY BENEFITS:

- | Wide display surface for optimal visibility
- | Sturdy stainless steel display surfaces
- | Stainless steel bumper
- | Strong tempered glass
- | Protection against glass fogging
- | Multiplexible device
- | Wide choice of colors for the exterior (RAL pallet)
- | Even allocation of cool air throughout the whole area
- | Energy-saving electronically commutated fans
- | Electronic control panel
- | Polyurethane thermal insulation CFC free

MM	2500	3750			
°	N/A				

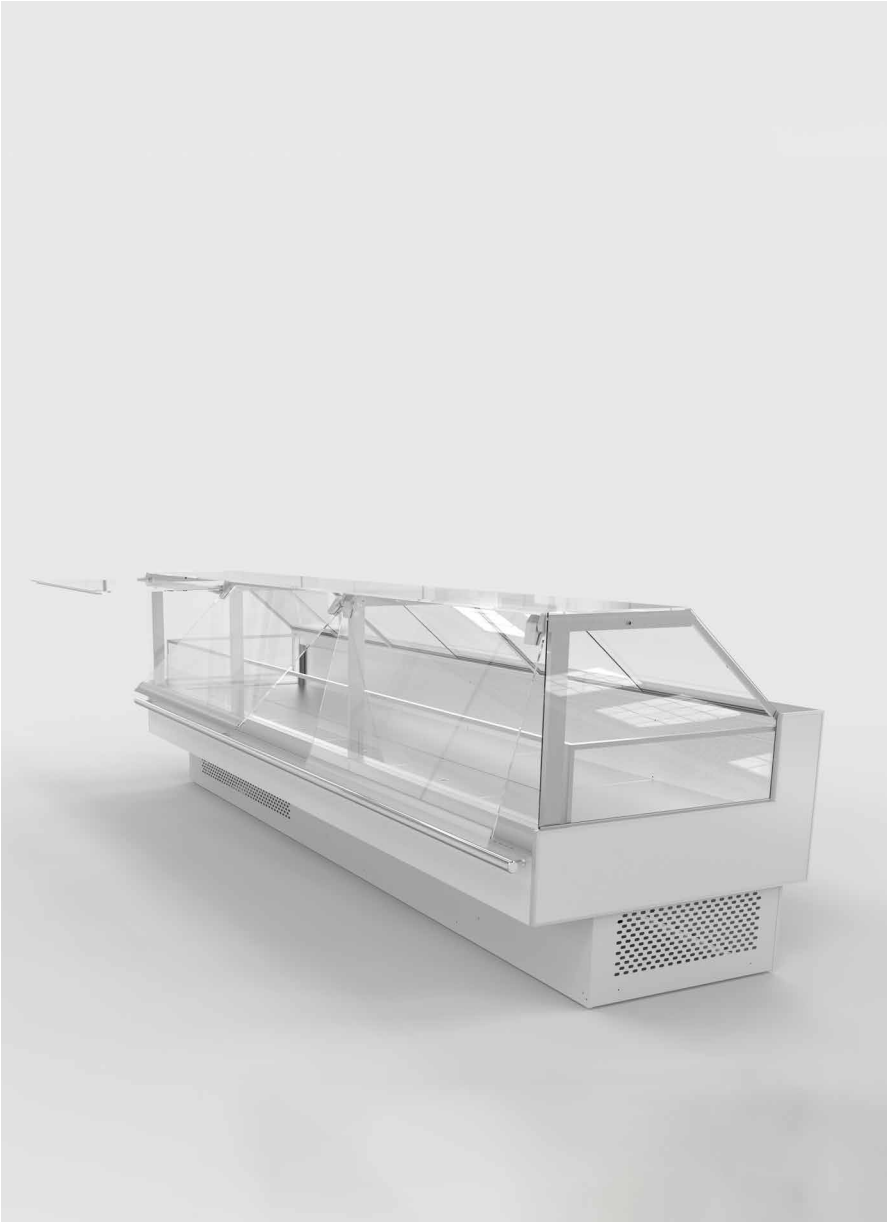
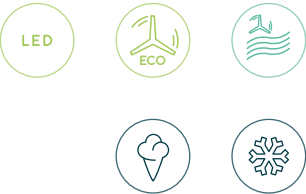

	HFC / HFO	CO ₂	R290
PLUG-IN	✓		✓
REMOTE	✓	✓	
HYDROLOOP	✓		✓

Model	Lenght without endwalls (mm)	Operating temperature °C (+25 °C, 60% RH)	Exposition space (m²)	Volume (m³)	Rated voltage (V)
Vega QB Freezer	2500 3750	-12...-15 °C	2.88 3.19	0.49 0.73	400

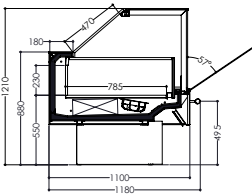

Vega QB Freezer



ACCESSORIES
to improve customers experience

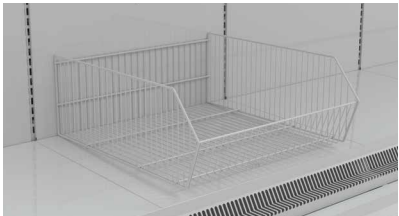

Wire bottom basket



Wire bottom basket with rails



Wire bottom basket with dividers

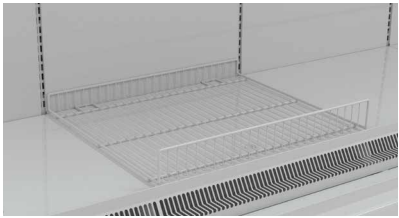

Wire bottom deck

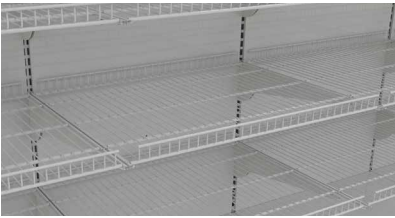

Wire shelf



Wire shelf divider



Price holder

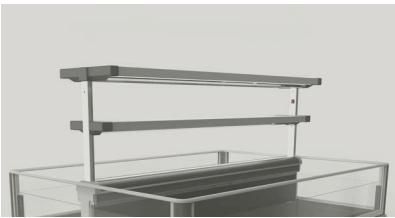

Superstructure with 1 or 2 shelves



Divider for freezer island

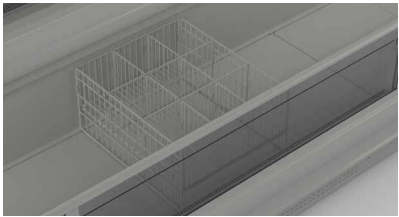

9 compartment divider for freezer island



Adjustable bottom wire shelf for freezer island

OPTIONS

perfectly tailored to your needs

GLASS LID OPTIONS

- 1 | Sliding lids
- 2 | Push lids

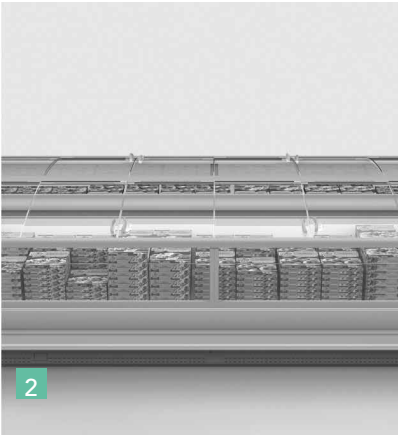
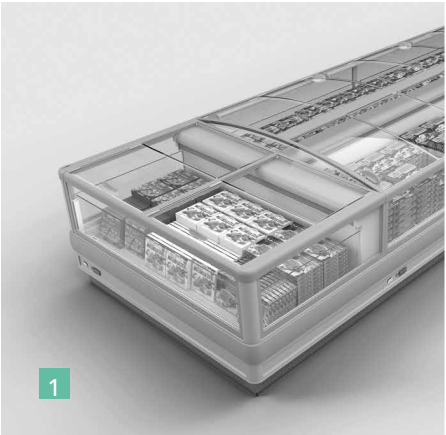















ENDWALL OPTIONS

- 1 | Solid endwall
- 2 | Panoramic endwall



ICON LEGEND

 Static cooling	 Dynamic cooling	 LED lighting	 Energy saving fan	 Fresh meat	 Fresh fish	 Fresh fruit and vegetables	 Drinks
 Milk and dairy products	 Cheese	 Cakes and bakery	 Ready meals and salads	 Flowers	 Ice cream	 Frozen food	 Hot meals

CONTACTS

where you can find us

HEAD OFFICE

FREOR LT, UAB

Katiliskiu St. 92,
LT-02212 Vilnius,
Lithuania
T: +370 5 232 9188
E: info@freor.com

REPRESENTATIVE OFFICES

FREOR PL SPÓŁKA Z O.O.

Targowisko 469,
32-015 Kłaj,
Poland
T: +48 12 307 22 74
E: freorpl@freor.com

FREOR REFRIGERATION, SOOO

Ul. Zadvorenskaja 8,
222666 Stolbtsy, Minsk Region,
Belarus
T: +375171772191
E: info@freor.by

FREOR RUS, OOO

Proezd Marshala Koneva, d. 28 E, of. 406,
214019 Smolensk, Smolensk Oblast,
Russia
T: +7 4812 686448
E: freor-ru@freor.com



FREEZERS

www.freor.com

Innovative food refrigeration solutions for every store



FREOR LT is not affiliated with Chemours or FREON.